

Phase :
Mise à l'enquête complémentaire CAMAC n° 237 190

Construction d'un chalet familial en résidence principale et
d'un couvert à voitures

Morcellement de la parcelle 2379

Parcelle n°2379

Chemin de la Vuarnaz 26
1865 Les Diablerets
Commune d'Ormont-Dessus

Propriétaires

Mme Céline BRAZK
M. Brian JACCARD

Plan de Protection Incendie



Dates : 06.11.2024

Echelle : 1:100

Bérénice ANDRÉ Architecture (RAQ 1)

Petit-Chêne 13 - 3961 Ayer
Tél. +41 79 712 16 04
Mail: bereniceandre@hotmail.com

Légende :

-  Existant
-  A démolir
-  A construire

Signatures :

L'architecte :

Les propriétaires :

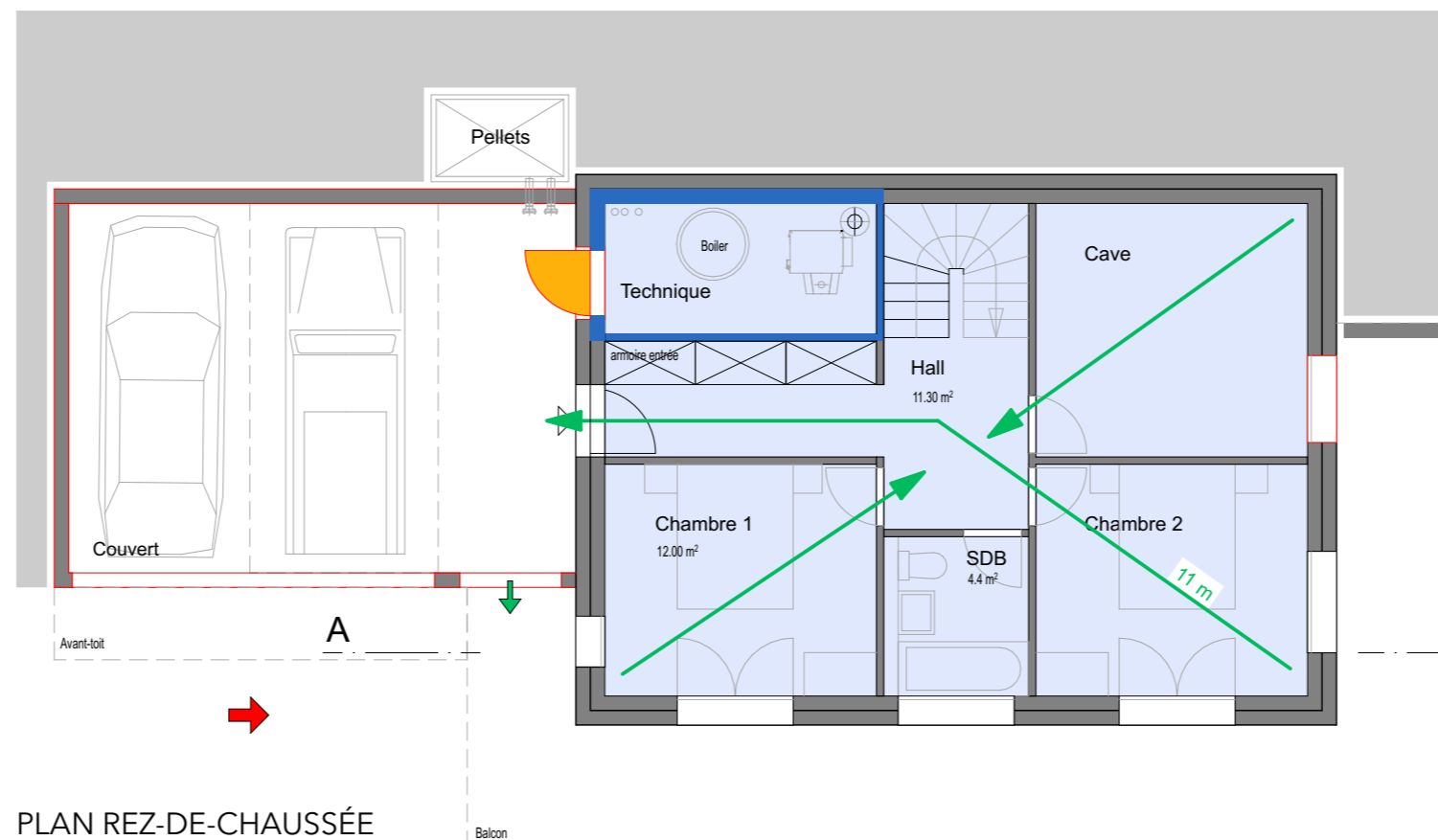
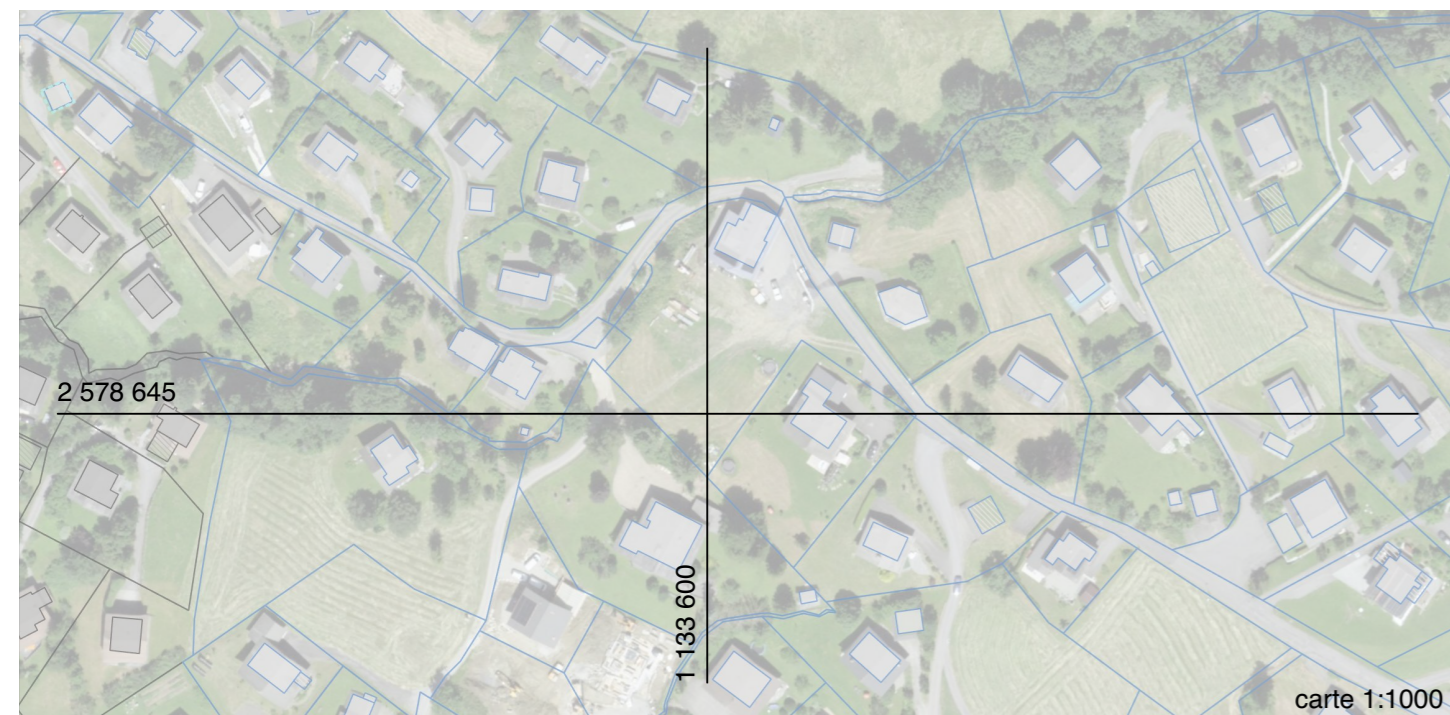



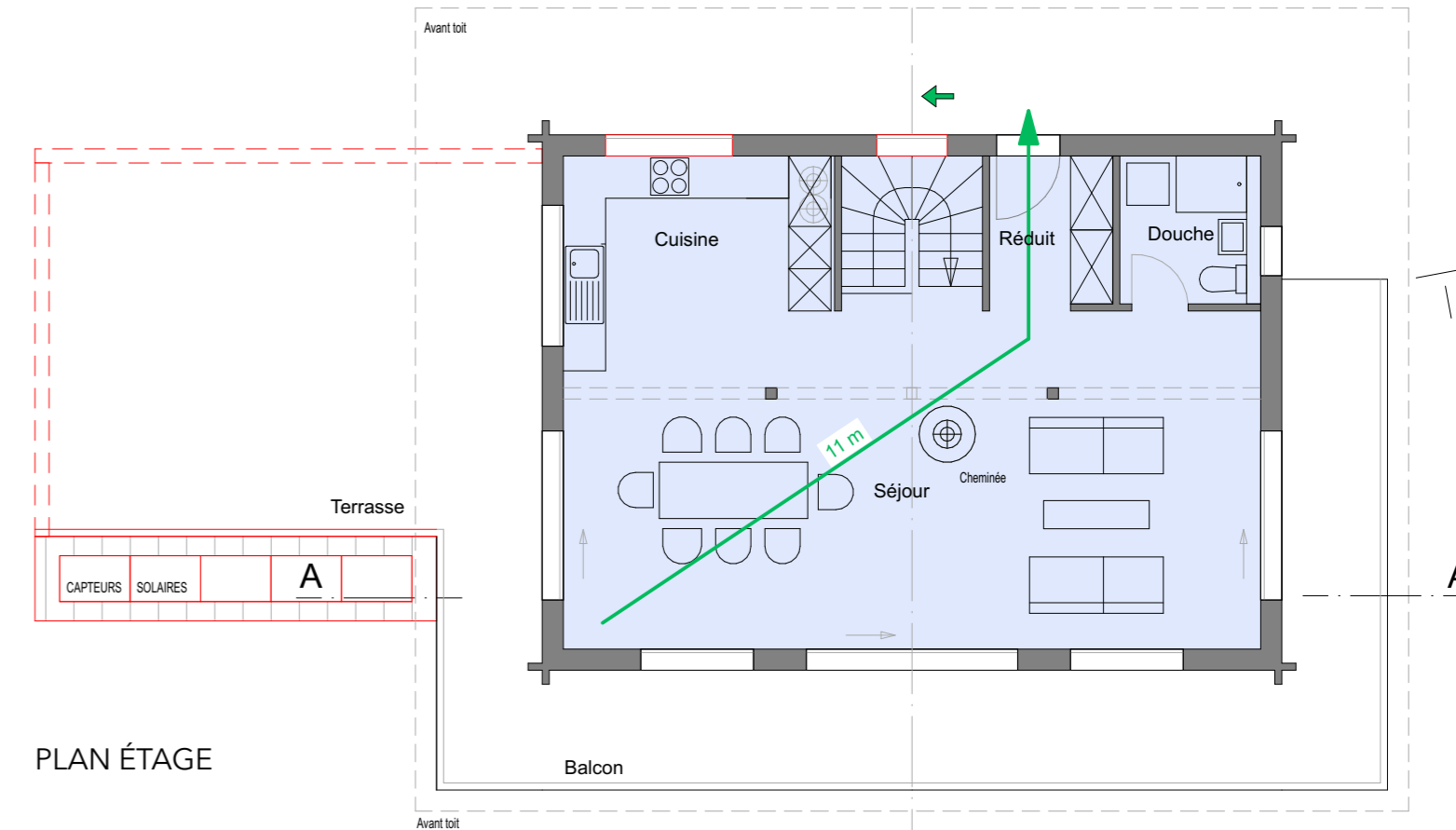







PLAN REZ-DE-CHAUSSEE

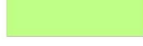

PLAN ÉTAGE

Légendes :

-  Résistance au feu EI 60-RF1
-  Résistance au feu EI 60
-  Résistance au feu EI 30
-  Porte EI30
-  Accès principal sapeurs-pompiers
-  Accès centrale sprinklers
-  Unité d'utilisation
-  Voie d'évacuation verticale
-  Voie d'évacuation horizontale
-  Surface à laisser libre
-  Sortie de secours
-  Longueur voie d'évacuation

